

The Tangram Garden

1. The basic layout

The basic layout maintains a free view SW, fills with plants the two laterals SE and NW and establish a central area. There would be two seating areas and the possibility of a circular pathway. There would be a covered area just after the entrance.

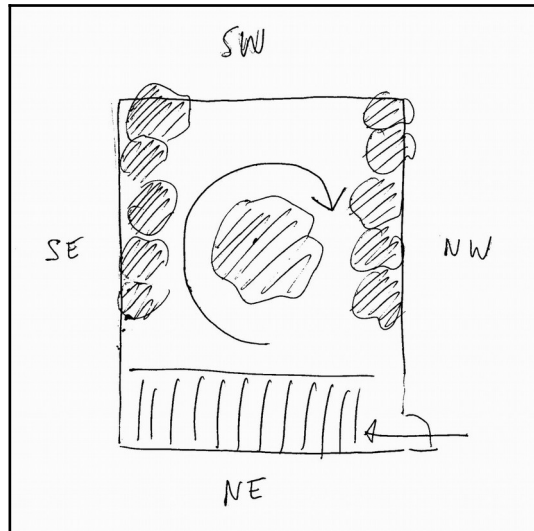
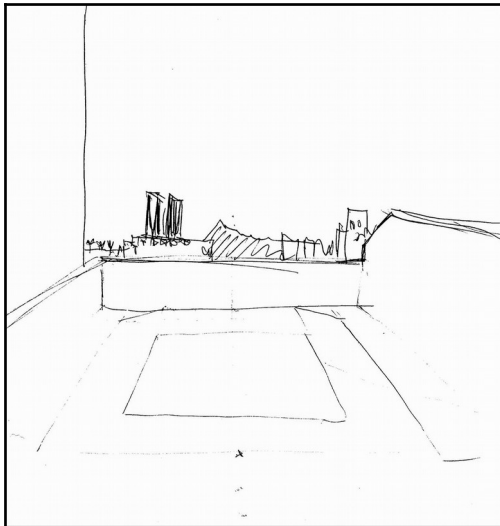

2. Tangram?

The need to ensure humidity isolation suggested the separation of the plant containers from the floor.

The requirement for the capability of redistribution of space depending on occasional circumstances suggested building mobile containers.

What shape, size and number of containers should be? The idea of mobile containers suggested something like playing with a puzzle. And so I came to the idea of using the traditional chinese seven-piece puzzle, the tangram.

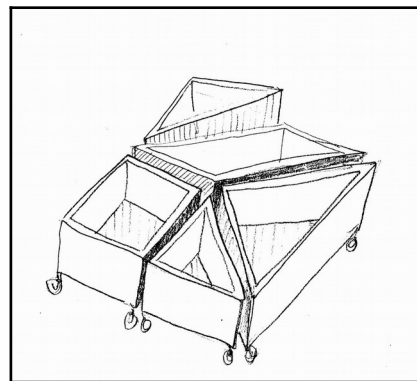
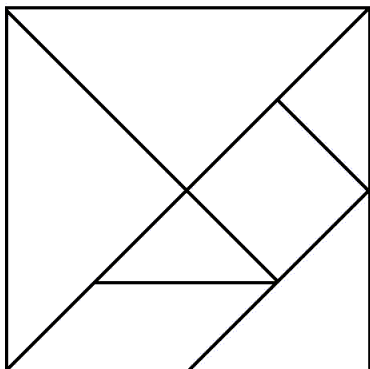

3. Three tangrams

Now the challenge was to assign a Tangram pattern to the basic layout. After some attempts the best option appeared to be three tangram sets each one measuring 1.5x3 meters.

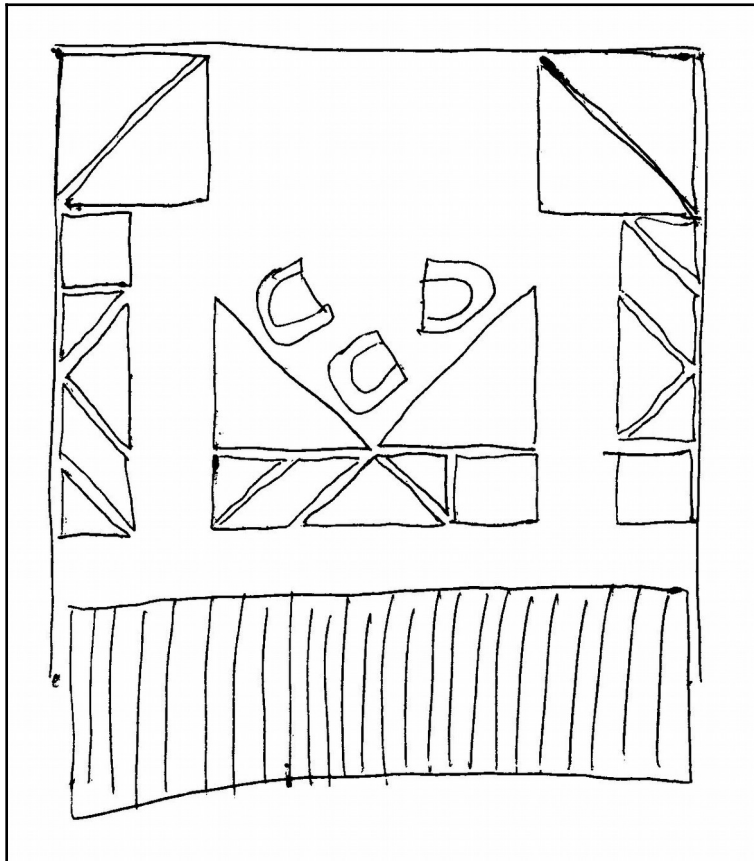

Three tangrams in three areas, it seemed also natural to make two groups within each tangram, i) the two biggest triangles ii) the five smaller pieces.

4. SE, Water garden and formal garden

The south-east zone limits with a tall building; it receives sun in the afternoon and the evening. The two big triangles would host a formal landscape: the triangle in the back, magnolia, buxus for topiary and small roses; the one in front, a parterre arrangement which reproduces the tangram pattern. The five smaller pieces would be for the water garden, two distributions available:

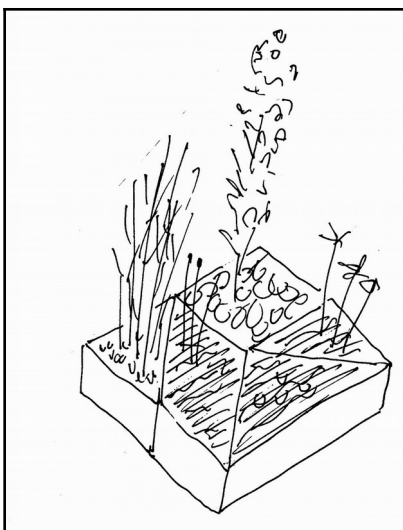
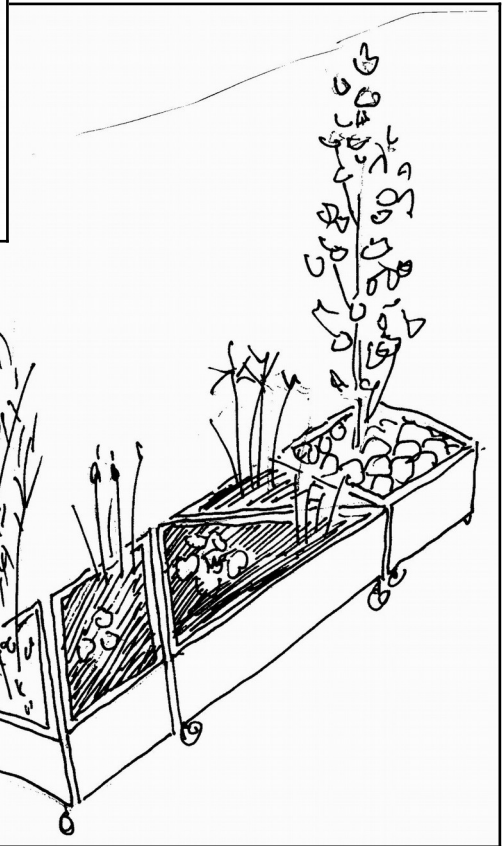
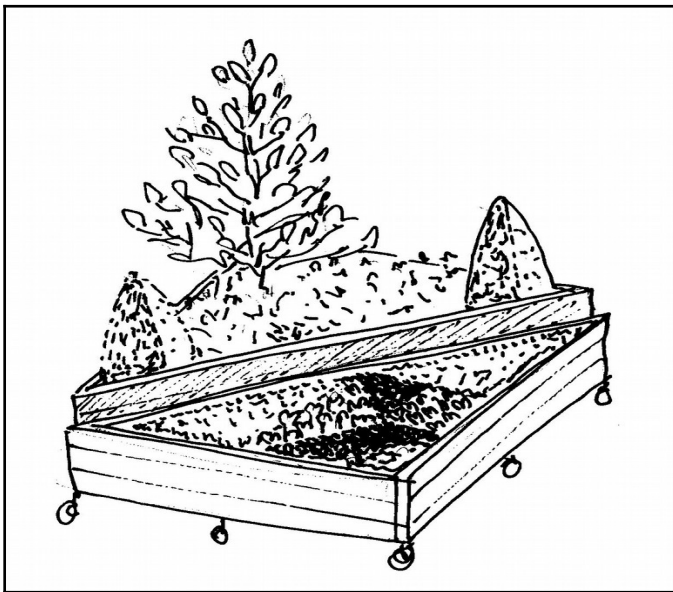

5. NW, Vegetable garden and coast garden

The north-west zone receives sun from mid morning to mid afternoon, it would be the place for a vegetable garden and the coast landscape (sand and the natural palm tree that can be found in the catalan seashore, *chamaerops humilis*).

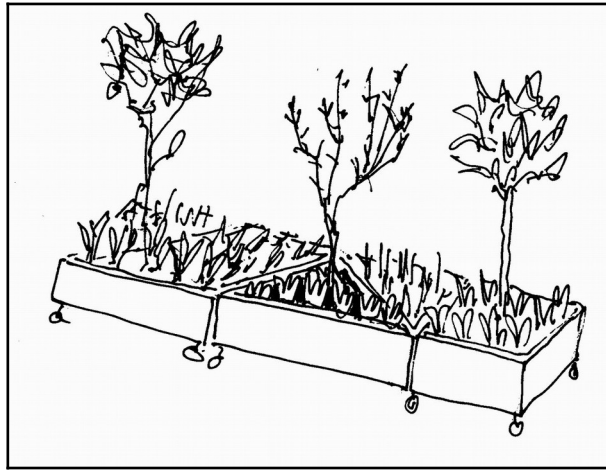

6. Central area, wild plants and forest

Here the two big triangles will have a variety of wild plants that can be found in the margins of roads, paths or tracks. The set of five smaller pieces would be for plants of mediterranean forest, including a pine and a cork tree.

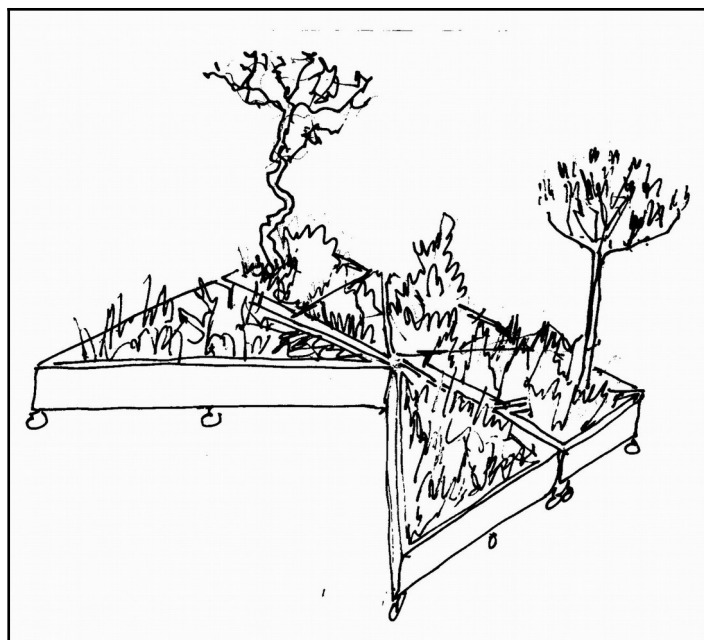

7. Containers and pergolas

The containers would be made on a base of iron frame, a wire gauze, a plastic bag fabric and walls out of treated wood.

Two pergolas with movable screens would protect from the sun if necessary.

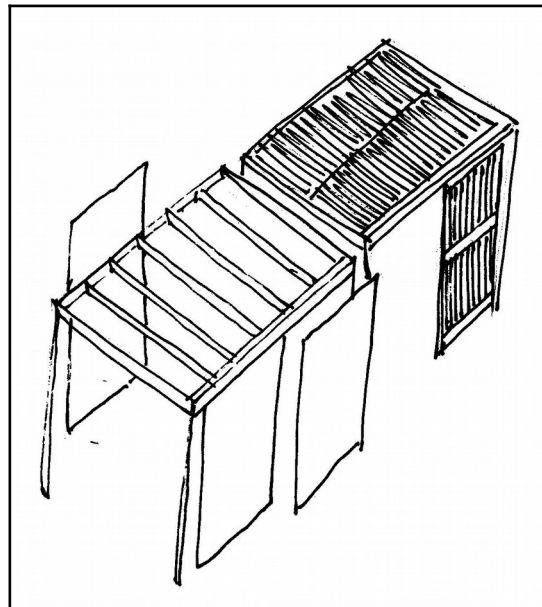
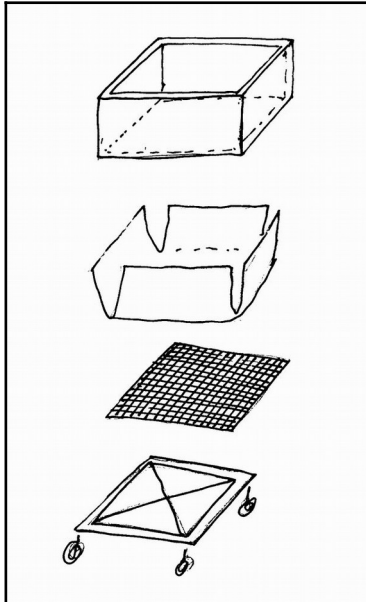

8. Playing with the tangram

There are many options to distribute the containers. I shall sketch only a few.

WA: Water garden
FR: Formal garden
CO: Coast garden
VE: Vegetable garden
WL: Wild garden
FO: Forest garden

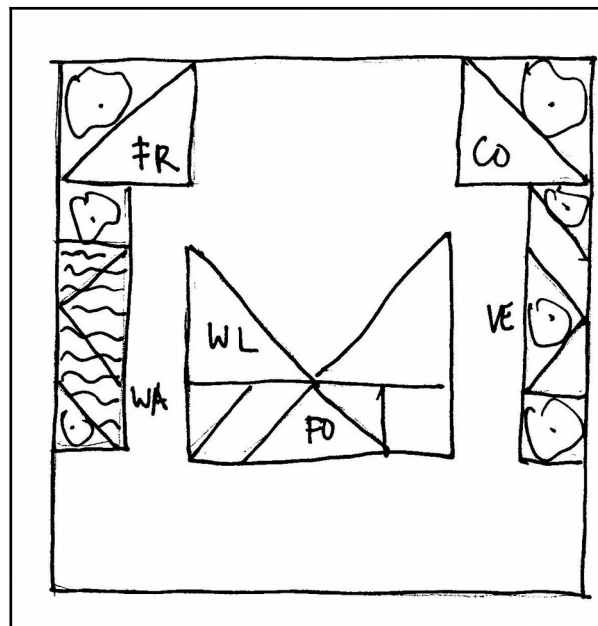

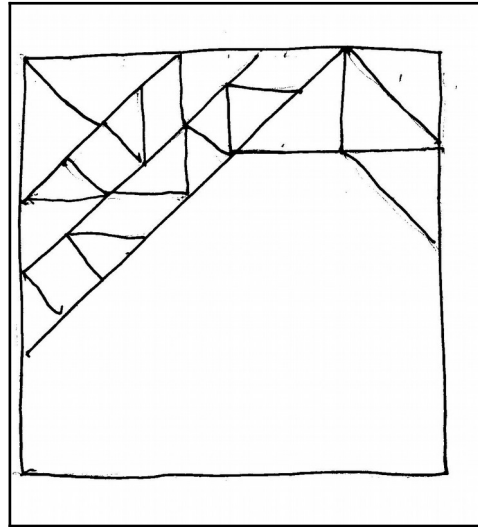
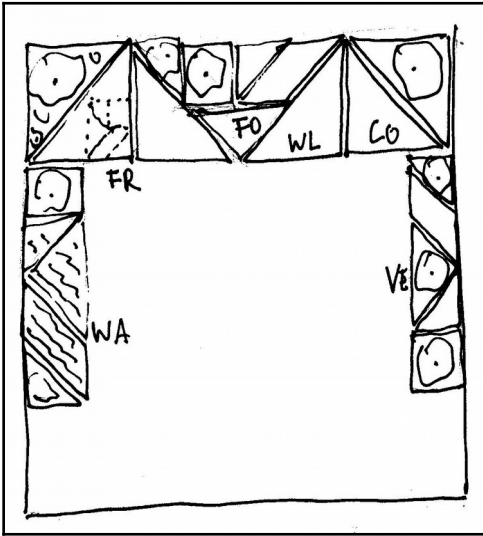

Distributions that allow more free space

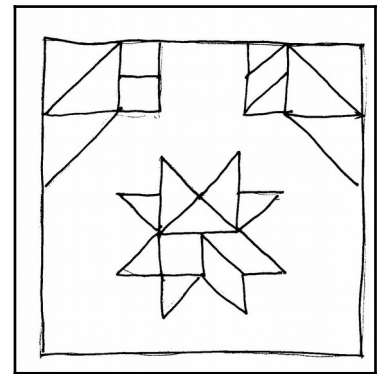
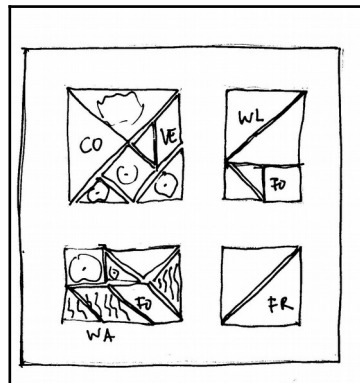
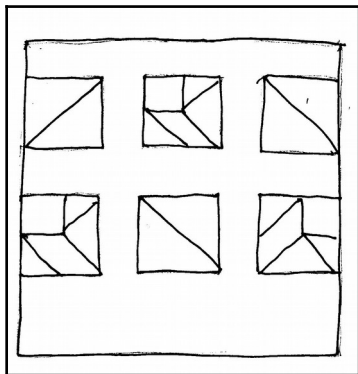

Distributions with separate combinations

9. Next steps

The photos below show the existing tangram garden. There is also an automatic watering circuit that can be easily removed if the containers are to be redistributed. Now there is still a long way until the plants achieve their mature shape.

I am preparing further developments in a smaller scale, dividing by two the length of containers (which means dividing the surface by four).

So the next tangram set would be 75cm. x 150cm. I am thinking mobile platforms without walls and having only tiny green undulated hills, some stones and sand:

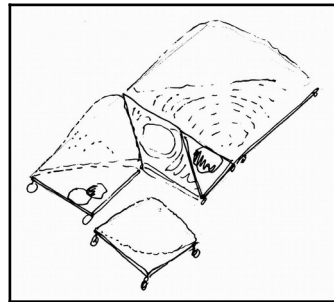

The next one would be just 37.5 cm x 75 cm. At this scale, the tangram pieces would be fine for bonsai containers.

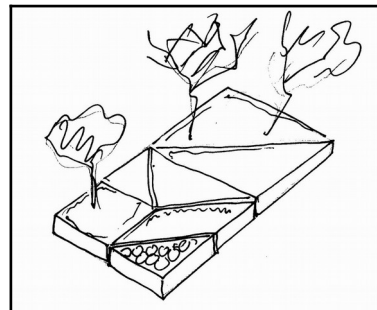

And last, a set of 18.75 cm. x 37.5 cm could be a set of glass vases for flower arrangements.

